



ลูกดัง



จั่งจ๋



PRODUCTS CATALOG

THE MORTAR EXPERT



มอก.2735-2559

มอก.3056-2563

มอก.3202-2564

มอก.598-2566

มอก.2703-2566

มอก.1776-2566



Quick Coat Products Co., Ltd. is a manufacturer and distributor mortar. The Company was founded in 1993 by a group of experts in many fields such as chemists, engineers and geologists who jointly developed a mortar product that is most suitable for plastering lightweight block. With the determination and endeavor of the experiment, we have developed **The first and the best plastering mortar for lightweight block in Thailand** under the brand **"PLUMB"** or **"RED PLUMB"** and the masonry mortar for lightweight block under the brand **"KANGAROO 2IN1 Masonry and Tile Adhesive Mortar"** or **"PURPLE KANGAROO"** which were well known among all builders to this day



QUICKCOAT

Over the past 30 years, we have produced more than **1 billion bags** of mortar-helping build over **4 million homes**. We have been part of many of the country's leading projects, delivering countless smiles and happiness to families everywhere.

We are committed to delivering the best-quality mortar into the hands of every craftsman and customer, true to our mission of being the **"The Mortar Expert"**





Head Office
Nakhon In Rd., Nonthaburi



Factory
Mueang District, Ratchaburi Province on an area of over 90 rai.

- 

QUICK Delivery
Fast delivery service.
- 

QUICK Technical Support
Fast technical service.
- 

QUICK Customer Service
Fast customer service.

Robotic Production system 100%

Our mortar is produced with German production technology, and we also serve as a distribution hub supplying retailers and construction sites across Thailand.



มอก.2735-2559

มอก.3056-2563

มอก.3202-2564

มอก.598-2566

มอก.2703-2566

มอก.1776-2566

International quality standard and environmental friendliness



We carefully select premium raw materials to produce high-quality mortar.



Our production is powered by clean, renewable energy generated by over 2,000 solar panels.



Every batch is strictly inspected, ensuring every bag meets our quality standards before delivery.

Plastering



Plastering Mortar for Lightweight Block CP001

Plastering Mortar for General Block CP105

Plastering Mortar for Concrete Block CP003

Masonry



Masonry and Tile Adhesive Mortar CP007

Masonry Mortar for General Block CP008

Wall Repair



Crack Repair Mortar (with Sand) CP046/E

Crack Repair Mortar (without Sand) CP046/E1

Tile Adhesive



Masonry and Tile Adhesive Mortar CP007

SuperSave Tile Adhesive Mortar (BLUE KANGAROO) JA101

Standard Tile Adhesive Mortar (GREEN KANGAROO) JA201

Waterproof Tile Adhesive Mortar (RED KANGAROO) JA301

Highest Strength Tile Adhesive Mortar (GOLDEN KANGAROO) JA401

KANGAROO Tile Grout CP064

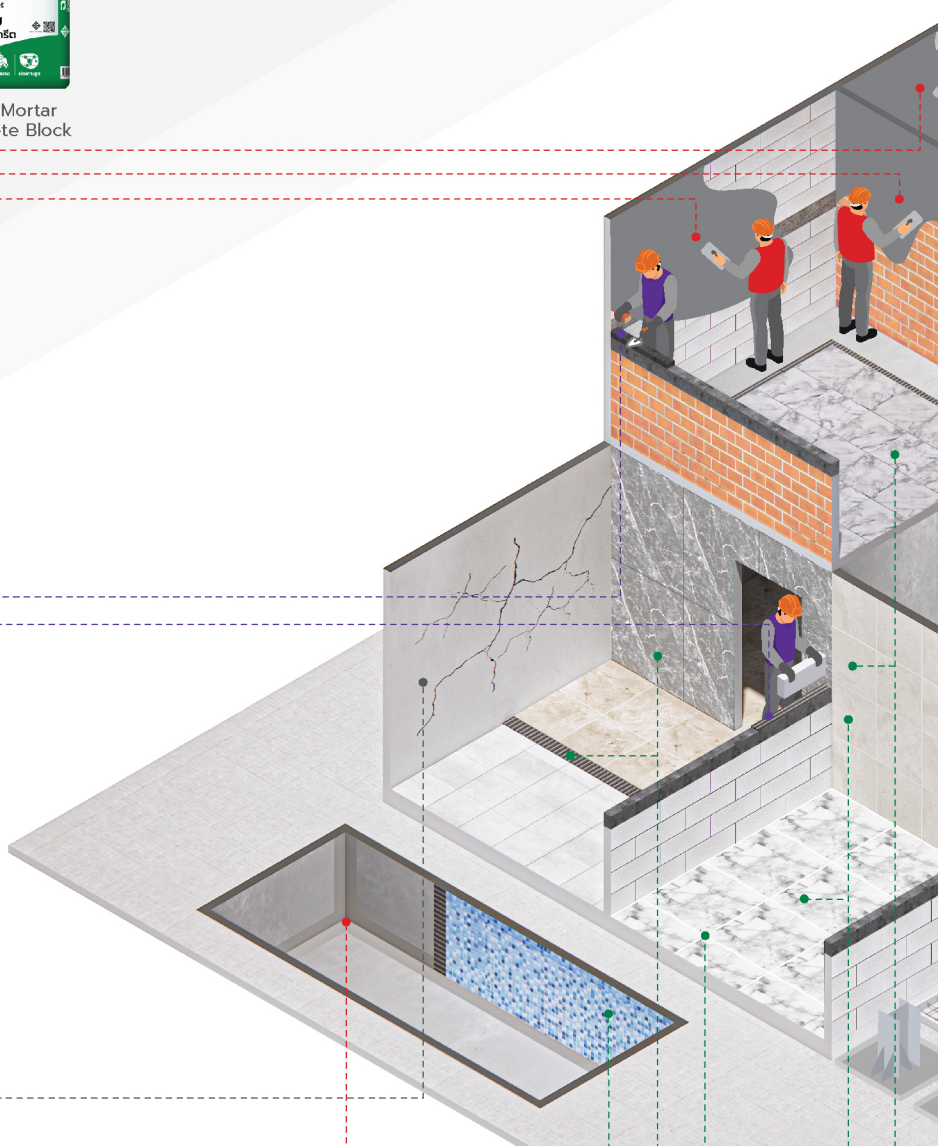

Skimcoat



Skimcoat (White)
CP015/A



Skimcoat (Grey)
CP051



Skimcoat (Light Grey)
CP015/K



Super Skimcoat
(White)
CP015/B



Skimcoat
(Loft Style)
CP015/L

Construction Chemicals



PLUMB
Water Repellent
Semi-Gloss
DS-22



PLUMB
Bonding Agent Latex
DB-77



PLUMB 2K
Flexible waterproofing
cement 2K
DW201

NEW



Easy Floor Screed
JF101



Floor Levelling
Mortar
CP009



Dry Premixed
Concrete
CP104



Non-Shrink Grout
CP052

Flooring

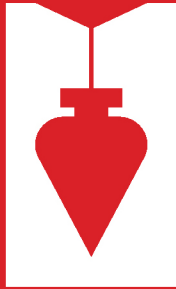

ลูกตั้ง

PLUMB, Good Mortar and a Builder's Secret

A **plumb (Lookding)** is a tool for builders. It is a plummet with a pointed end and a rope attached at the other. It is used to find a vertical line perpendicular to the earth to serve as a reference line for construction.

A **plumb** is also one of the tools of Vishnu, the father of construction, held in his left hand. All Thai builders considered it as a symbol of precise and accurate construction.

PLUMB is a representative brand of mortar products for plastering, skim coat and special repair under Quick Coat Products Co., Ltd.

"RED PLUMB"

Plastering Mortar for Lightweight Block is our first product that has established a reputation for our organization, the characteristics of plumb also reflect the vision of management and business practices of an organization that focuses on precision, fairness and honesty to customers, partners and employees in the organization.





มอก.2735-2559

PLUMB

Plastering Mortar for Lightweight Block



No.1

Plastering Mortar For Lightweight Block



มอก.3056-2563

PLUMB

Skim Coat



A flawless wall finish

100%^{*}

flawless coverage

*For covering small hairline cracks or coarse sand-textured walls, apply at a thickness of no more than 2 mm.



Comparison of applications of products

Plastering



CP001



CP105



CP003



CP015/A

Type of product

Plastering Mortar
for Lightweight
Block

Plastering Mortar
for General Block

Plastering Mortar
for Concrete Block

Skim Coat
(White)

Wall material

Lightweight block



Red block, General block, White block



Concrete structure



For use with mortar sprayers



Decoration and Repair surfaces

Fixing coarse-grained, uneven, wavy wall, hairline crack



Bare cement wall, concrete wall ***



Prefabricated wall (Precast, Wall panel, Tunnel form) ***



Soft wall (fiber cement, gypsum board, cement board) ***



Loft Cement for Decoration

Old wall, Painted wall (Modification)

For use with skim coat sprayer



Other

Crack Repair

Bonding between old concrete and new concrete

Loft walls, Polished mortar, Brick wall, Terracotta tiles,

Sand stone,

Waterproofing

Bathrooms, Kitchens, Balconies, Decks and Swimming pools

Indoor and outdoor plastered wall



Basic repair, **Repairing and preventing cracks, *Surface finishing for formwork joints*

Plastering

คู่มืออิฐมวลเบา



CP001

PLUMB Plastering Mortar for Lightweight Block

Properties

- For plastering on lightweight block and red block, concrete block, and white block
- Good bonding strength and reduced cracks thanks to special fibers added
- Contain water retention agent preventing water loss
- Smoother plastered surface due to fine sand
- Soft and smooth texture, easy to plaster without much effort
- Can be used with a plastering mortar sprayer
- Suitable for both indoor and outdoor applications
- Certified with TIS 2735-2559

Area Coverage (sq.m./bag)

- Cover an area of approximately 2.6 sq.m. at a thickness of 1 cm.

Pack Size : 40 kg/bag



SCAN



มท.2735-2559

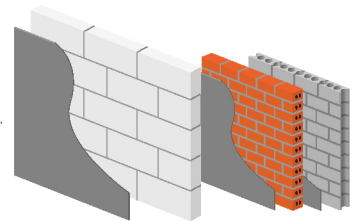

CP105

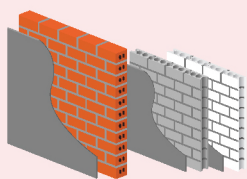

มท.1776-2566

PLUMB Plastering Mortar for General Block

Properties

- For plastering on red block, concrete block, and white block
- Good bonding strength and reduced cracks thanks to special fibers added
- Contain water retention agent preventing water loss
- Smoother plastered surface due to fine sand
- Soft and smooth texture, easy to plaster without much effort
- Can be used with a plastering mortar sprayer
- Suitable for both indoor and outdoor applications
- Certified with TIS 1776-2566

Area Coverage (sq.m./bag)

- Cover an area of approximately 2.4 sq.m. at a thickness of 1 cm.

Pack Size : 40 kg/bag



SCAN



CP003



มท.1776-2566

PLUMB Plastering Mortar for Concrete Block

Properties

- For plastering on concrete structure, column-beam, floor, staircase and elevator concrete wall
- Good bonding strength with reduced peeling off
- Contain water retention agent preventing water loss
- For plastering concrete surfaces (CO). The mortar offers high bond strength and adheres more firmly than general plastering mortar.
- Soft and smooth texture, easy to plaster without much effort
- Can be used with a plastering mortar sprayer
- Suitable for both indoor and outdoor applications
- Certified with TIS 1776-2566

Area Coverage (sq.m./bag)

- Cover an area of approximately 2.4 sq.m. at a thickness of 1 cm.

Pack Size : 40 kg/bag



SCAN

Thin Plastering / Skim Coat

ผนังเนียนสวย 100%



CP015/A

PLUMB Skim Coat for Decoration and Repair Surfaces (White)

Properties

- Can be used on both bare cement wall and primed wall (Can be applied over existing paint without removing the old coating)
- For fixing coarse-grained, uneven, wavy wall and surface finishing for formwork joints or tiny holes
- For wall application to repair and finish defects along joints between concrete formwork panels
- Contain a variety of specially selected aggregates and special adhesion promoter
- Can be used on bare wall, concrete wall, precast wall, soft wall
- Strong and tough cement surface but easy to polish without much effort
- Suitable for both indoor and outdoor applications
- Certified with TIS 3056-2563

Area Coverage (sq.m./bag)

- Cover an area of approximately 20-25 sq.m. at a thickness of 1-2 mm.

Pack Size : 20 kg/bag



SCAN



มท.3056-2563



CP051



มท.3056-2563



CP015/K

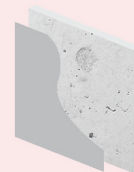

มท.3056-2563

PLUMB Skim Coat for Decoration and Repair Surfaces (Grey)

Properties

- Can be used on both bare cement wall and primed wall (Can be applied over existing paint without removing the old coating)
- For fixing coarse-grained, uneven, wavy wall and surface finishing for formwork joints or tiny holes
- For wall application to repair and finish defects along joints between concrete formwork panels
- Contain a variety of specially selected aggregates and special adhesion promoter
- Can be used on bare wall, concrete wall, precast wall, soft wall
- Strong and tough cement surface but easy to polish without much effort
- Suitable for both indoor and outdoor applications
- Certified with TIS 3056-2563

Area Coverage (sq.m./bag)

- Cover an area of approximately 20-25 sq.m. at a thickness of 1-2 mm.

Pack Size : 20 kg/bag



SCAN

PLUMB Skim Coat for Decoration and Repair Surfaces (Light Grey)

Properties

- Can be used on both bare cement wall and primed wall (Can be applied over existing paint without removing the old coating)
- For fixing coarse-grained, uneven, wavy wall and surface finishing for formwork joints or tiny holes
- For wall application to repair and finish defects along joints between concrete formwork panels
- Contain a variety of specially selected aggregates and special adhesion promoter
- Can be used on bare wall, concrete wall, precast wall, soft wall
- Strong and tough cement surface but easy to polish without much effort
- Suitable for both indoor and outdoor applications
- Certified with TIS 3056-2563

Area Coverage (sq.m./bag)

- Cover an area of approximately 20-25 sq.m. at a thickness of 1-2 mm.

Pack Size : 20 kg/bag



SCAN

Thin Plastering / Skim Coat (Modification)



สำหรับ
งานรีโนเวท



CP015/B

PLUMB Super Skim Coat for Decoration and Repair Surfaces (White)

Properties

- For Decoration and Repair Surfaces
 - New wall : bare cement wall, concrete wall, unpainted surface. or primed surface
 - Old wall : can be used on painted wall without the need to peel off the old paint*
- This mortar is formulated with a carefully selected blend of multiple aggregates and additives to deliver maxim
- For fixing coarse-grained, uneven, wavy wall and surface finishing for formwork joints or tiny holes
- For wall application to repair and finish defects along joints between concrete
- Can be used on bare wall, concrete wall, precast wall, soft wall
- Strong and tough cement surface but easy to polish without much effort
- Suitable for both indoor and outdoor applications
- Certified with TIS 3056-2563

Area Coverage (sq.m./bag)

- Cover an area of approximately 20-25 sq.m. at a thickness of 1-2 mm.

Pack Size : 20 kg/bag



SCAN



มทท.3056-2563



CP015/L

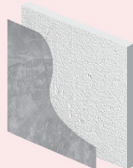

มทท.3056-2563



CP046/E1



PLUMB Loft Cement for Decoration

Properties

- For decorative loft wall plastering, and to help correct uneven or imperfect wall surfaces
- Produced from genuine cement. Its natural cement color delivers an authentic loft-style texture
- Can be used on all surfaces
 - New wall : bare cement wall, concrete wall, unpainted surface. or primed surface
 - Old wall : can be used on painted wall without the need to peel off the old paint*
- Applies with a clear loft-style pattern, easy to sand—no wall sander needed
- Great value—yields more coverage per use
- Suitable for both indoor and outdoor applications
- Certified with TIS 3056-2563

Area Coverage (sq.m./bag)

- Cover an area of approximately 20-25 sq.m. at a thickness of 1-2 mm.

Pack Size : 20 kg/bag



SCAN

PLUMB Crack Repair Mortar

Properties

- For repairing cracked walls (white mortar).
- Sand-mixed type - contains fine sand, suitable for general plastered cement walls.
- Non-sand type - smooth, fine texture, suitable for skim-coated walls.
- High flexibility-up to 50%.
- Suitable for use on concrete, glass, wood, and plastic surfaces.
- Suitable for both indoor and outdoor use

Area Coverage (sq.m./bag)

- For thin plastering or putty, cover an area of approximately 3-6 sq.m.

Pack Size : 1 kg/bag



SCAN

*For slippery surfaces with anti-adhesion such as oil-painted surface, shield painted surface or surface with paint peeling off or deteriorated paint, the paint must be removed before applying the product.

Construction Chemicals



DW201

PLUMB 2K Flexible Waterproofing Cement

Properties

- For waterproofing before tile installation as bathrooms, kitchens, balconies, decks and swimming pools.
- Good flexibility and excellent adhesion
- 100% waterproof
- Conceal small cracks and cover surface pores
- Resistant to weather condition, sun, rain, water pressure
- Can be left as bare surface or painted
- Convenient, fast and easy to mix
- Suitable for indoor and outdoor applications

Area Coverage (sq.m./bag)

- Covering an area of approximately 9 sq.m. (2 coats)

Pack Size : Part A 18 kg, Part B 1 L

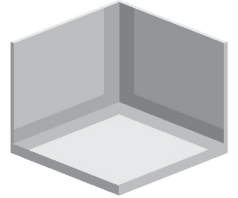

DB-77

PLUMB Bonding Agent Latex

Properties

- For adhesion between existing and new floor
- Excellent adhesion strength, preventing peeling off
- Reduces cracking
- Reduces water leakage
- Suitable for various applications, such as floor leveling, concrete surface repair, and tile adhesive, etc.
- Convenient, easy to use, and environmentally friendly
- Suitable for indoor and outdoor applications

Area coverage (sq.m./bag)

- A 1 L-bag can cover an area of approximately 15-20 sq.m.
- A 5 L-bag can cover an area of approximately 75-100 sq.m.

Pack Size : 1 L/bag, 5 L/bag



DS-22

PLUMB Water Repellent Semi-Gloss Coating

Properties

- For wall coating and decorative surfaces
- Waterproof, prevents mold, algae and dirt buildup
- Maintains the original surface color, making the loft pattern clearly visible
- Prevents hard water stains when exposed to moisture
- Resistant to environmental conditions, UV light, sunlight, rain
- Durable and anti-dust, protects and maintains original color of surface
- Suitable for many types of walls such as loft walls, polished mortar, exposed brick wall, terracotta tiles, sandstone, exposed aggregate finish
- Safe without a pungent smell as it doesn't contain any thinner
- Suitable for indoor and outdoor applications

Area Coverage (sq.m./bag)

- A 1 L-bag can cover an area of approximately 8-14 sq.m.
- A 4.5 L-bag can cover an area of approximately 36-63 sq.m.

Pack Size: 1 L/bag, 4.5 L/bag





คังคัง

KANGAROO, a good helper for builder

Kangaroo is the national animal of Australia. It is a marsupial mammal with special pouch for its baby. It has long, strong hind legs for long jumps and a strong tail for balance. Kangaroo is a high-energy, alert, gregarious, family-loving and friendly animal.

KANGAROO, or known as "PURPLE KANGAROO" among the builders, is the first masonry mortar brand for lightweight block in Thailand with a technology from Australia combining with modern innovations to meet the needs of surface and structural works.

KANGAROO is a representative brand of mortar products for concrete structure, adhesive, and concrete floor under Quick Coat Products Co., Ltd.

In addition, the characteristics of kangaroo reflect the enthusiasm, optimism and friendliness that Quick Coat strives to offer its customers through unsurpassed and accessible service. The kangaroo also represents the identity of the executive who drives the organization with positive energy and treats its personnel like his own family members.



NEW

KANGAROO 2IN1

**No.1 Masonry
and Tile Adhesive**



High Bond Strength Floor-Wall

**Tested to tile-adhesive standards;
suitable for both floor and wall applications. For indoor use only.*

NEW

KANGAROO Floor Leveling Mortar

At a thickness of 1-3 cm



Smooth & Strong No cracking, No peeling

Ready for All flooring materials

- ✓ Tile Adhesive
- ✓ Rubber tile
- ✓ Laminate
- ✓ Parquet
- ✓ SPC



จ๊อง

Comparison of applications of products

Mansory



CP007



CP008



CP007

Type of product

Masonry and
Tile Adhesive
Mortar

Masonry Mortar
for General Block

Masonry and
Tile Adhesive
Mortar

Wall material

Lightweight block



Red block, General block, White block



Tiles

Terracotta tile, mosaic, ceramic tile (normal water absorption)



Porcelain tile, Granito (low water absorption)



Marble, granite (for interior wall and floor covering)

Natural stone

Glass mosaic, Resin mosaic

Tiles Sizes

Small : 15x15 - 45x45 cm.



Medium : 60x60 cm.



Large : 90x90 cm., 60x80 cm., 60x120 cm.

Extra large : 100x100 cm.

Super Extra : 100x150 cm.

Area

No need to immerse the tiles in water before installation



Indoor floor



Indoor wall



Outdoor floor

Outdoor wall

Swimming pool

Spical surface

Tiling over existing tile

Fiber cement board, Cement board, Structural plywood

Gypsum board

Cement Grout

Grout line width: 1-6 mm.

Prevents and inhibits black mold

Reduces water leakage, the cause of the fungus.

Floor

Floor Leveling 1-3 cm. Floor leveling before laying tiles, rubber tile, laminate, parquet, etc.

Floor Leveling 3-5 cm. Floor leveling for rough or polished concrete floor

Ligament and lintel such as reinforced concrete flashing, countertop, terrace

Grouting concrete surface, leveling precast concrete column base,
leveling concrete column head for beam support, leveling steel plate base for
machine installation and steel column base

**Basic repair work*



เหนียว..คุณ2*



CP007

KANGAROO 2IN1 Masonry and Tile Adhesive Mortar

Masonry Mortar for Lightweight Block

- Highest quality masonry mortar for lightweight block wall
- Quick dry masonry mortar, reducing the need to pour water on the blocks before masonry
- Tough and not crumbly texture with short setting time
- Excellent adhesion within 10 seconds with right setting time for block alignment.
- Apply in a thin layer to save material—only 2–3 mm thick

Area Coverage (sq.m./bag)

Lightweight block wall

Block thickness	7.5 cm.	10 cm.
Average coverage	26 sq.m	19.5 sq.m

Pack Size : 40 kg/bag

**Tested to tile-adhesive standards; suitable for both floor and wall applications. For indoor use only.*

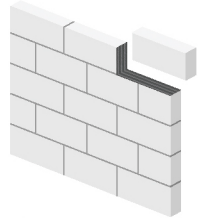

CP008

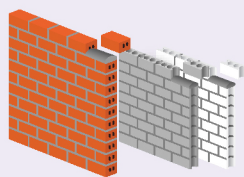

KANGAROO Masonry Mortar for General Block

Properties

- Masonry mortar for general block such as red block, concrete block and white block
- Contains a variety of special selected aggregates for good bonding strength, durable, tough
- Strong and sticky, bonds well to bricks, and provides high strength
- Contains water retention agent
- Convenient, easy to use, and delivers quality results
- Suitable for small storage areas, high-rise buildings or additions
- Certified with TIS 598-2566

Area Coverage (sq.m./bag)

Area coverage at a line thickness of 1-1.5 cm

Type of block	Red block	Concrete block	White block
Average coverage	1.0 sq.m	2.1 sq.m	1.9 sq.m

Pack Size : 40 kg/bag



CP009



KANGAROO Floor Leveling Mortar 3-5 cm.

Properties

- General floor leveling, floor leveling for tiling, floor leveling for rough or polished concrete floor
- Contains special selected aggregates and high-quality chemicals for improved fluidity, easy floor leveling
- Strong and durable—helps reduce cracking and peeling
- More cost-saving, faster to work with, and delivers high-quality results

Area Coverage (sq.m./bag)

• Cover a floor area of approximately 0.45-0.75 sq.m at a thickness of 3-5 cm

Pack Size : 40 kg/bag



Flooring and Leveling



NEW



JF101

KANGAROO Floor Leveling Mortar 1-3 cm.

Easy Floor Screed

Properties

- Suitable for floor leveling, thin leveling, concrete floor for decorative materials, such as rubber tile, laminate, parquet, etc.
- Made with a specially selected blend of premium ingredients, Good fluidity, easy floor leveling
- Smooth, tough and durable floor, reduces cracking
- Cost savings, get quality results faster

Area Coverage (sq.m./bag)

- Covering an area of approximately 0.60-2.0 sq.m. at a thickness of 1-3 cm

Pack Size : 40 kg/bag



SCAN



CP104

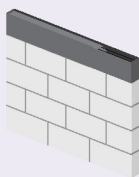

สนท.3202-2564

NEW



JN450

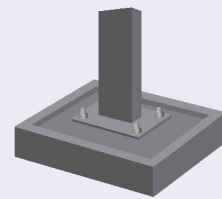

KANGAROO Dry Premixed Concrete (240 KSC)

Properties

- For general concrete pouring. Compressive stress up to 240 KSC
- Suitable for pouring concrete for tie columns and lintels, concrete countertops, and reinforced concrete wing-wall construction projects
- High quality concrete for better fluidity, convenience, quick and stronger
- Reduce air gap after removing the formwork ensuring high-quality work
- Fast and convenience, suitable for the site with limited storage space
- Certified with TIS 3202-2564

Area Coverage (sq.m./bag)

- Cover an area of approximately 0.40 sq.m. at a thickness of 5 cm

Pack Size : 40 kg/bag



SCAN

KANGAROO Non-Shrink Grout (450 KSC)

Properties

- For load-bearing grouting to fill gaps and voids between concrete-to-concrete and concrete-to-steel structures, such as: grouting to fill cavities/voids on concrete surfaces; grouting for leveling and bedding precast concrete column bases; grouting joints between concrete wall panels or other precast structural joints; and grouting for leveling steel base plates supporting machinery loads and steel column bases. Especially suitable for high-load applications, with compressive strength up to 450 ksc
- Contains a specially selected blend and high-quality chemical additives to improve flowability.
- Easy to pour, strong floor surface with minimal shrinkage.
- Easy to pour into formwork without leaving voids.

Area Coverage (sq.m./bag)

- Cover an area of approximately 0.20-0.25 square meters at a thickness of 3-5 cm

Pack Size : 40 kg/bag



SCAN

Tile Adhesive

ติดผนัง พื้น-ผนัง



CP007

KANGAROO 2IN1 Masonry and Tile Adhesive Mortar

Tile Adhesive

- Great for tiles up to 60x60 cm
- Suitable for tiles with as terracotta tile, ceramic, granito and porcelain
- Reduces the work steps by eliminating the immersion process
- Tough texture with right setting time for tile alignment
- Excellent adhesion strength
- Excellent tile adhesion
- Suitable for both floor and wall, indoor applications

Area Coverage (sq.m./bag)

Tile adhesive

Size of notched trowel	3 mm.	6 mm.	9 mm.	12 mm.
Approximate area coverage	12 sq.m	6 sq.m	4 sq.m	3 sq.m

Pack Size : 40 kg/bag

**Tested to tile-adhesive standards; suitable for both floor and wall applications. For indoor use only.*



SCAN

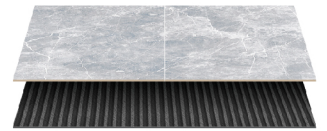

JA101

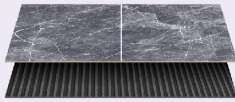

BLUE KANGAROO Super Save Tile Adhesive Mortar

Properties

- Great for tiles up to 60x60 cm
- Suitable for tiles with as terracotta tile, ceramic, granito and porcelain
- Reduces the work steps by eliminating the immersion process
- Tough texture with right setting time for tile alignment
- Excellent adhesion strength
- Excellent tile adhesion
- Suitable for both floor and wall, indoor applications

Area Coverage (sq.m./bag)

Tile adhesive

Size of notched trowel	3 mm.	6 mm.	9 mm.	12 mm.
Approximate area coverage	12 sq.m	6 sq.m	4 sq.m	3 sq.m

Pack Size : 20 kg/bag



SCAN



JA301

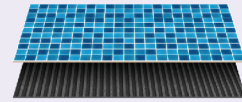

RED KANGAROO Waterproof Tile Adhesive Mortar

Properties

- Can be used to install large tiles up to 100x100 cm
- For installation of general tiles, ceramics, mosaics, porcelain, granitos, marble, granite (natural stone size of 60x60 cm)
- Reduces the work steps by eliminating the immersion process
- Excellent adhesion
- Resistant to water, chlorine, salt water (Pool Standards)
- Durable even in waterlogged conditions, bathrooms, kitchens and swimming pools
- Suitable for both floor and wall, indoor and outdoor applications
- Certified with TIS 2703-2566

Area Coverage (sq.m./bag) Tile adhesive

Size of notched trowel	3 mm.	6 mm.	9 mm.	12 mm.
Approximate area coverage	12 sq.m	6 sq.m	4 sq.m	3 sq.m

Pack Size : 20 kg/bag



สทศ.2703-2566



SCAN

Tile Adhesive



JA201

GREEN KANGAROO Standard Tile Adhesive Mortar

Properties

- Great for large tiles up to 90x90* cm
- Suitable for tiles with as terracotta tile, ceramic, granito, porcelain and mosaic
Ideal for marble and granito up to 60x80 cm (for flooring)
- Reduces the work steps by eliminating the immersion process
- High bond strength
- Tough texture with long setting time for tile alignment
- Good adhesion, durable, and not peeling off
- Suitable for both floor and wall, indoor and outdoor applications
- Certified with TIS 2703-2566

Area Coverage (sq.m./bag) Tile adhesive

Size of notched trowel	3 mm.	6 mm.	9 mm.	12 mm.
Approximate area coverage	12 sq.m	6 sq.m	4 sq.m	3 sq.m

Pack Size : 20 kg/bag

**For wall tiles 60x60 cm and larger, temporary supports (nails/ledger) are recommended to prevent slippage.*



SCAN



มท.2703-2566



JA401



มท.2703-2566



CP064

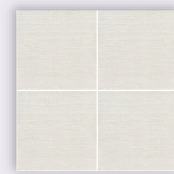

GOLDEN KANGAROO Highest Strength Tile Adhesive Mortar

Properties

- Suitable for extra large tiles 100x100 cm and over
- For installation of general tiles, ceramics, mosaics, porcelains, granitos, marble, granite, natural stone and glass mosaic
- Can be used on all surfaces and materials such as plywood, fiber cement board, viva board and cement board.
- You can lay tiles over the existing tiles
- Good flexibility with highest adhesion strength
- Sticky and tough texture for good adhesion, durable, eliminating tile falling off
- Resistant to vibration
- Suitable for both floor and wall, indoor and outdoor applications
- Certified with TIS 2703-2566

พื้นที่การใช้งาน (ตร.ม./ถุง) กาวติดกระเบื้องได้พื้นที่ดังนี้

Size of notched trowel	3 mm.	6 mm.	9 mm.	12 mm.
Approximate area coverage	12 sq.m	6 sq.m	4 sq.m	3 sq.m

Pack Size : 20 kg/bag



SCAN

KANGAROO Premium Cement Grout (White)

Properties

- Suitable for general tile grout.
- Excellent adhesion, eliminating tile falling off
- Reduces stubborn dirt stain buildup with hydrophobic agent added
- Reduces water leakage, the cause of the fungus.
- Prevents and inhibits black mold
- Long service life with greater durability without cracking
- Ideal for grouting indoor and outdoor floor or wall
- Grout line width : 1-6 mm.

Area Coverage (sq.m./bag)

- Covering an area of approximately 4-23 sq.m.

Pack Size : 1 kg/bag



SCAN



The Crystal Solana
Ekamai - Raminthra



The Grand
Pinklao



Malton Gates
Krungthep Kreetha



S'RIN
Ratchapruerk-Sai 1



SMYTH'S
Kaset-Nawamin



Nantawan
Rama 9 - New Krungthep Kreetha



Bangkok Boulevard Rama 9
Raminthra - Seri Thai 2



Silverlake Vind
Suwinthawong 78 - Nong Chok



Siri Place
Ratchapruerk-Nakhonin



Baan puripuri
Lat Phrao 41

REFERENCES



One Bangkok
Lumpini



Reignwood Park
Pathumthani



Sonle Residences
Wongsawang



Bu Gaan
Yothinpattana



Burasiri
Krungthep Kreetha



Coco Parc Condo
Rama 4



Whizdom the Forestias
Bangna



Once Pattaya
Pattaya



RISE 46
Watcharapol-Sukhapiban 5



Hampton Residence
Phyathai



Rhythm
Ekamai

QUICKCOAT | THE MORTAR EXPERT

Quick Coat Products Co.,Ltd.

184 moo 7 Nakhon In Rd., Bang Khu Wiang, Bang Kruai, Nonthaburi 11130

☎ 02 408 9888 🌐 www.quickcoat.co.th 📺 📞 📱 @quickcoat

☎ Technical Support Hotline 02 408 9888 ext. 204



SCAN ME